

ANSI and RPM FLANGE UNIONS AND FLANGES

How to specify 8767A, 8767B, 8767C, 8767D, and 8767E Flanges.

8767

Option III

**S** = Single: one flange, one gasket, hardware to accommodate companion flange thickness as follows:  
8767A, 8767B, 8767C: up to 1 1/2"  
8767D, 8767E: up to 3/4"

**P** = Orifice plate: two flanges, two gaskets, hardware to accommodate an orifice plate up to 3/8" thick.

**U** = Union: two flanges, one gasket, hardware.

**V** = Wafer valve: two flanges, two gaskets, hardware to accommodate the corresponding N.A. wafer valves: 1136, 45, 46, 55 and 56. (For butterfly and automatic shutoff valves use two "S" assembly flanges.)

**H** = 8697-7 Orifice holder: two flanges, type A or type C only. Two gaskets, 6 through bolts, washers and nuts. 4 blind hole bolts and washers.

**R** = Resilient seat valve: two flanges, hardware to accommodate N.A. 1154 Valve (gaskets not needed).

Option II

North American Pipe Code

Option I

(Product Designation)

**A** = ANSI Class 150 steel, slip-on welding, flat face

**B** = ANSI Class 150 steel, slip-on welding, raised face (except for 1154 resilient seat valves, not suitable as a companion flange for N.A. products because of raised face)

**C** = ANSI Class 150, steel, screwed, flat face

**D** = Fabricated low pressure air--RPM drilling

**E** = Fabricated low pressure air--150 ANSI type drilling

NOTE: 500 F service is the temperature limitation for standard gaskets. For higher temperature service consult North American.

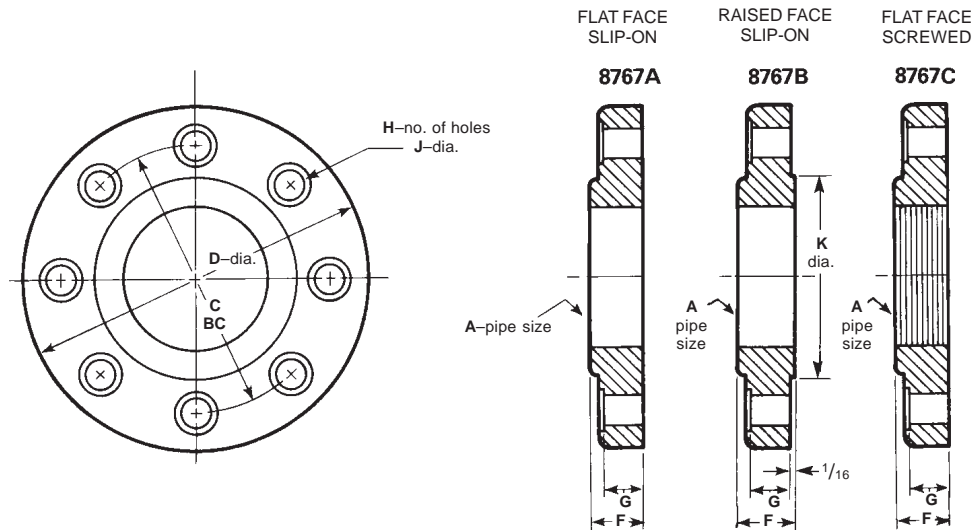

8767A and 8767B ANSI CLASS 150 STEEL SLIP-ON WELDING FLANGES

North American can supply ANSI (American National Standards Institute) Class 150 steel, slip-on welding flanges. 8767A Flat Face Flanges can be used (for example) as companion flanges with N.A. 1518 or 1519 Automatic Shutoff Valves and NA wafer valves 14" and under when slip-on welding connections are preferred. 8767B Flanges with raised face make suitable unions in fuel pipe lines.

Flange designation	dimensions in inches								Flange only wt, lb
	A	C	D	F	G	H	J		
8767A-01	1/2	2 <sup>3</sup> / <sub>8</sub>	3 <sup>1</sup> / <sub>2</sub>	5/8	7/16	4	5/8	1	
8767A-0	3/4	2 <sup>3</sup> / <sub>4</sub>	3 <sup>7</sup> / <sub>8</sub>	5/8	1/2	4	5/8	2	
8767A-1	1	3 <sup>1</sup> / <sub>8</sub>	4 <sup>1</sup> / <sub>4</sub>	1 <sup>1</sup> / <sub>16</sub>	9/16	4	5/8	2	
8767A-2	1 <sup>1</sup> / <sub>4</sub>	3 <sup>1</sup> / <sub>2</sub>	4 <sup>5</sup> / <sub>8</sub>	1 <sup>3</sup> / <sub>16</sub>	5/8	4	5/8	3	
8767A-3	1 <sup>1</sup> / <sub>2</sub>	3 <sup>7</sup> / <sub>8</sub>	5	7/8	1 <sup>1</sup> / <sub>16</sub>	4	5/8	3	
8767A-4	2	4 <sup>3</sup> / <sub>4</sub>	6	1	3/4	4	3/4	5	
8767A-5	2 <sup>1</sup> / <sub>2</sub>	5 <sup>1</sup> / <sub>2</sub>	7	1 <sup>1</sup> / <sub>8</sub>	1 <sup>1</sup> / <sub>16</sub>	4	3/4	8	
8767A-6	3	6	7 <sup>1</sup> / <sub>2</sub>	1 <sup>3</sup> / <sub>16</sub>	3/4	4	3/4	8	
8767A-7	4	7 <sup>1</sup> / <sub>2</sub>	9	1 <sup>5</sup> / <sub>16</sub>	1 <sup>5</sup> / <sub>16</sub>	8	3/4	12	
8767A-8	6	9 <sup>1</sup> / <sub>2</sub>	11	1 <sup>9</sup> / <sub>16</sub>	1	8	7/8	19	
8767A-9	8	11 <sup>3</sup> / <sub>4</sub>	13 <sup>1</sup> / <sub>2</sub>	1 <sup>3</sup> / <sub>4</sub>	1 <sup>1</sup> / <sub>8</sub>	8	7/8	30	
8767A-10	10	14 <sup>1</sup> / <sub>4</sub>	16	1 <sup>15</sup> / <sub>16</sub>	1 <sup>3</sup> / <sub>16</sub>	12	1	43	
8767A-12	12	17	19	2 <sup>3</sup> / <sub>16</sub>	1 <sup>1</sup> / <sub>4</sub>	12	1	64	
8767A-14	14	18 <sup>3</sup> / <sub>4</sub>	21	2 <sup>1</sup> / <sub>4</sub>	1 <sup>3</sup> / <sub>8</sub>	12	1 <sup>1</sup> / <sub>8</sub>	90	
8767A-16	16	21 <sup>1</sup> / <sub>4</sub>	23 <sup>1</sup> / <sub>2</sub>	2 <sup>1</sup> / <sub>2</sub>	1 <sup>7</sup> / <sub>16</sub>	16	1 <sup>1</sup> / <sub>8</sub>	98	
8767A-18	18	22 <sup>3</sup> / <sub>4</sub>	25	2 <sup>11</sup> / <sub>16</sub>	1 <sup>9</sup> / <sub>16</sub>	16	1 <sup>1</sup> / <sub>4</sub>	130	
8767A-20	20	25	27 <sup>1</sup> / <sub>2</sub>	2 <sup>7</sup> / <sub>8</sub>	1 <sup>11</sup> / <sub>16</sub>	20	1 <sup>1</sup> / <sub>4</sub>	165	

Flange designation	dimensions in inches								Flange only wt, lb
	A	C	D	F	G	H	J	K	
8767B-01	1/2	2 <sup>3</sup> / <sub>8</sub>	3 <sup>1</sup> / <sub>2</sub>	1 <sup>1</sup> / <sub>16</sub>	7/16	4	5/8	1 <sup>3</sup> / <sub>8</sub>	1
8767B-0	3/4	2 <sup>3</sup> / <sub>4</sub>	3 <sup>7</sup> / <sub>8</sub>	1 <sup>1</sup> / <sub>16</sub>	1/2	4	5/8	1 <sup>11</sup> / <sub>16</sub>	2
8767B-1	1	3 <sup>1</sup> / <sub>8</sub>	4 <sup>1</sup> / <sub>4</sub>	3/4	9/16	4	5/8	2	2
8767B-2	1 <sup>1</sup> / <sub>4</sub>	3 <sup>1</sup> / <sub>2</sub>	4 <sup>5</sup> / <sub>8</sub>	7/8	5/8	4	5/8	2 <sup>1</sup> / <sub>2</sub>	3
8767B-3	1 <sup>1</sup> / <sub>2</sub>	3 <sup>7</sup> / <sub>8</sub>	5	1 <sup>5</sup> / <sub>16</sub>	1 <sup>1</sup> / <sub>16</sub>	4	5/8	2 <sup>7</sup> / <sub>8</sub>	3
8767B-4	2	4 <sup>3</sup> / <sub>4</sub>	6	1 <sup>1</sup> / <sub>16</sub>	3/4	4	3/4	3 <sup>5</sup> / <sub>8</sub>	5
8767B-5	2 <sup>1</sup> / <sub>2</sub>	5 <sup>1</sup> / <sub>2</sub>	7	1 <sup>3</sup> / <sub>16</sub>	1 <sup>1</sup> / <sub>16</sub>	4	3/4	4 <sup>1</sup> / <sub>8</sub>	8
8767B-6	3	6	7 <sup>1</sup> / <sub>2</sub>	1 <sup>1</sup> / <sub>4</sub>	3/4	4	3/4	5	8
8767B-7	4	7 <sup>1</sup> / <sub>2</sub>	9	1 <sup>3</sup> / <sub>8</sub>	1 <sup>5</sup> / <sub>16</sub>	8	3/4	6 <sup>3</sup> / <sub>16</sub>	12
8767B-8	6	9 <sup>1</sup> / <sub>2</sub>	11	1 <sup>5</sup> / <sub>8</sub>	1	8	7/8	8 <sup>1</sup> / <sub>2</sub>	19
8767B-9	8	11 <sup>3</sup> / <sub>4</sub>	13 <sup>1</sup> / <sub>2</sub>	1 <sup>13</sup> / <sub>16</sub>	1 <sup>1</sup> / <sub>8</sub>	8	7/8	10 <sup>5</sup> / <sub>8</sub>	30
8767B-10	10	14 <sup>1</sup> / <sub>4</sub>	16	2	1 <sup>3</sup> / <sub>16</sub>	12	1	12 <sup>3</sup> / <sub>4</sub>	43
8767B-12	12	17	19	2 <sup>1</sup> / <sub>4</sub>	1 <sup>1</sup> / <sub>4</sub>	12	1	15	64
8767B-14	14	18 <sup>3</sup> / <sub>4</sub>	21	2 <sup>5</sup> / <sub>16</sub>	1 <sup>3</sup> / <sub>8</sub>	12	1 <sup>1</sup> / <sub>8</sub>	16 <sup>1</sup> / <sub>4</sub>	90
8767B-16	16	21 <sup>1</sup> / <sub>4</sub>	23 <sup>1</sup> / <sub>2</sub>	2 <sup>9</sup> / <sub>16</sub>	1 <sup>7</sup> / <sub>16</sub>	16	1 <sup>1</sup> / <sub>8</sub>	18 <sup>1</sup> / <sub>2</sub>	98
8767B-18	18	22 <sup>3</sup> / <sub>4</sub>	25	2 <sup>11</sup> / <sub>16</sub>	1 <sup>9</sup> / <sub>16</sub>	16	1 <sup>1</sup> / <sub>4</sub>	21	130
8767B-20	20	25	27 <sup>1</sup> / <sub>2</sub>	2 <sup>7</sup> / <sub>8</sub>	1 <sup>11</sup> / <sub>16</sub>	20	1 <sup>1</sup> / <sub>4</sub>	23	165

8767C ANSI CLASS 150 STEEL SCREWED FLAT FACE FLANGES

These also can be used as companion flanges with North American 1518 Manual Reset or 1519 Automatic Valves and NA wafer valves 14" and under.

Flange designation	dimensions in inches							Flange only wt, lb
	A	C	D	F	G	H	J	
8767C-01	1/2	2 <sup>3</sup> / <sub>8</sub>	3 <sup>1</sup> / <sub>2</sub>	5/8	7/16	4	5/8	1
8767C-0	3/4	2 <sup>3</sup> / <sub>4</sub>	3 <sup>7</sup> / <sub>8</sub>	5/8	1/2	4	5/8	2
8767C-1	1	3 <sup>1</sup> / <sub>8</sub>	4 <sup>1</sup> / <sub>4</sub>	1 <sup>1</sup> / <sub>16</sub>	9/16	4	5/8	2
8767C-2	1 <sup>1</sup> / <sub>4</sub>	3 <sup>1</sup> / <sub>2</sub>	4 <sup>5</sup> / <sub>8</sub>	1 <sup>3</sup> / <sub>16</sub>	5/8	4	5/8	3
8767C-3	1 <sup>1</sup> / <sub>2</sub>	3 <sup>7</sup> / <sub>8</sub>	5	7/8	1 <sup>1</sup> / <sub>16</sub>	4	5/8	3
8767C-4	2	4 <sup>3</sup> / <sub>4</sub>	6	1	3/4	4	3/4	5
8767C-5	2 <sup>1</sup> / <sub>2</sub>	5 <sup>1</sup> / <sub>2</sub>	7	1 <sup>1</sup> / <sub>8</sub>	1 <sup>1</sup> / <sub>16</sub>	4	3/4	7
8767C-6	3	6	7 <sup>1</sup> / <sub>2</sub>	1 <sup>3</sup> / <sub>16</sub>	3/4	4	3/4	7 <sup>1</sup> / <sub>2</sub>
8767C-7	4	7 <sup>1</sup> / <sub>2</sub>	9	1 <sup>5</sup> / <sub>16</sub>	1 <sup>5</sup> / <sub>16</sub>	8	3/4	11 <sup>1</sup> / <sub>4</sub>
8767C-8	6	9 <sup>1</sup> / <sub>2</sub>	11	1 <sup>9</sup> / <sub>16</sub>	1	8	7/8	16 <sup>3</sup> / <sub>4</sub>
8767C-9	8	11 <sup>3</sup> / <sub>4</sub>	13 <sup>1</sup> / <sub>2</sub>	1 <sup>3</sup> / <sub>4</sub>	1 <sup>1</sup> / <sub>8</sub>	8	7/8	28 <sup>1</sup> / <sub>4</sub>

8767D FABRICATED LOW PRESSURE AIR SLIP-ON FLANGES, RPM DRILLING

The following NA equipment matches RPM dimensions in 16" and up:

Wafer Valves:  
1145, 1146, 1155, 1156

Magna-Flame™ Burners  
4795, 5795, 6795, 4796, 5796, 6796

VHP Burners:  
4818, 5818, 6818

Hot Air Burners:  
4819, 5819, 6819, 4819- -A, 6819- -A

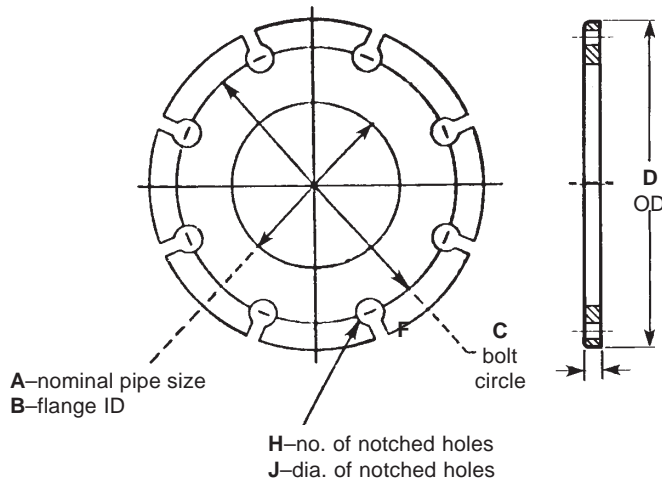

Flange designation	dimensions in inches							wt, lb
	A	B†	C	D	F	H	J	
8767D-6	3	3 <sup>9</sup> / <sub>16</sub>	4 <sup>3</sup> / <sub>4</sub>	6	3/8	4	5/8	2
8767D-7	4	4 <sup>9</sup> / <sub>16</sub>	5 <sup>15</sup> / <sub>16</sub>	7	3/8	8	5/8	3
8767D-8	6	6 <sup>11</sup> / <sub>16</sub>	7 <sup>7</sup> / <sub>8</sub>	9	1/2	8	5/8	6
8767D-9	8	8 <sup>3</sup> / <sub>4</sub>	10	11	1/2	8	5/8	7
8767D-10	10	10 <sup>7</sup> / <sub>8</sub>	12 <sup>1</sup> / <sub>4</sub>	14	1/2	12	3/4	12
8767D-12	12	12 <sup>7</sup> / <sub>8</sub>	14 <sup>1</sup> / <sub>4</sub>	16	1/2	12	3/4	14
8767D-14	14	14 <sup>1</sup> / <sub>8</sub>	16 <sup>1</sup> / <sub>4</sub>	18	5/8	12	3/4	20
8767D-16	16	16 <sup>1</sup> / <sub>8</sub>	19 <sup>1</sup> / <sub>4</sub>	21 <sup>1</sup> / <sub>4</sub>	5/8	16	3/4	31
8767D-18	18	18 <sup>1</sup> / <sub>8</sub>	21 <sup>1</sup> / <sub>4</sub>	23 <sup>1</sup> / <sub>4</sub>	5/8	16	3/4	36
8767D-20	20	20 <sup>1</sup> / <sub>8</sub>	23 <sup>1</sup> / <sub>8</sub>	25 <sup>1</sup> / <sub>4</sub>	5/8	20	3/4	38
8767D-22	22	22 <sup>1</sup> / <sub>8</sub>	26	28 <sup>1</sup> / <sub>4</sub>	5/8	20	3/4	51
8767D-24	24	24 <sup>1</sup> / <sub>8</sub>	27 <sup>3</sup> / <sub>4</sub>	30	3/4	20	3/4	64
8767D-26	26	26 <sup>1</sup> / <sub>4</sub>	29 <sup>3</sup> / <sub>4</sub>	32	3/4	24	7/8	66
8767D-28	28	28 <sup>1</sup> / <sub>4</sub>	31 <sup>3</sup> / <sub>4</sub>	34	3/4	28	7/8	71
8767D-30	30	30 <sup>1</sup> / <sub>4</sub>	33 <sup>3</sup> / <sub>4</sub>	36	3/4	28	7/8	75
8767D-32	32	32 <sup>1</sup> / <sub>4</sub>	35 <sup>3</sup> / <sub>4</sub>	38	3/4	28	7/8	80
8767D-34	34	34 <sup>1</sup> / <sub>4</sub>	37 <sup>3</sup> / <sub>4</sub>	40	3/4	32	7/8	85
8767D-36	36	36 <sup>1</sup> / <sub>4</sub>	39 <sup>3</sup> / <sub>4</sub>	42	3/4	32	7/8	89
8767D-38	38	38 <sup>1</sup> / <sub>4</sub>	41 <sup>3</sup> / <sub>4</sub>	44	3/4	32	7/8	94
8767D-40	40	40 <sup>1</sup> / <sub>4</sub>	43 <sup>3</sup> / <sub>4</sub>	46	3/4	36	7/8	99
8767D-42	42	42 <sup>1</sup> / <sub>4</sub>	45 <sup>3</sup> / <sub>4</sub>	48	3/4	36	7/8	103
8767D-44	44	44 <sup>1</sup> / <sub>4</sub>	47 <sup>3</sup> / <sub>4</sub>	50	3/4	40	7/8	108
8767D-46	46	46 <sup>1</sup> / <sub>4</sub>	49 <sup>3</sup> / <sub>4</sub>	52	3/4	40	7/8	112
8767D-48	48	48 <sup>1</sup> / <sub>4</sub>	51 <sup>3</sup> / <sub>4</sub>	54	3/4	44	7/8	117

† Based on standard steel pipe. For other types of pipe, alter B dimension to suit.

8767E FABRICATED LOW PRESSURE AIR SLIP-ON FLANGES with ANSI 150 TYPE\* DRILLING

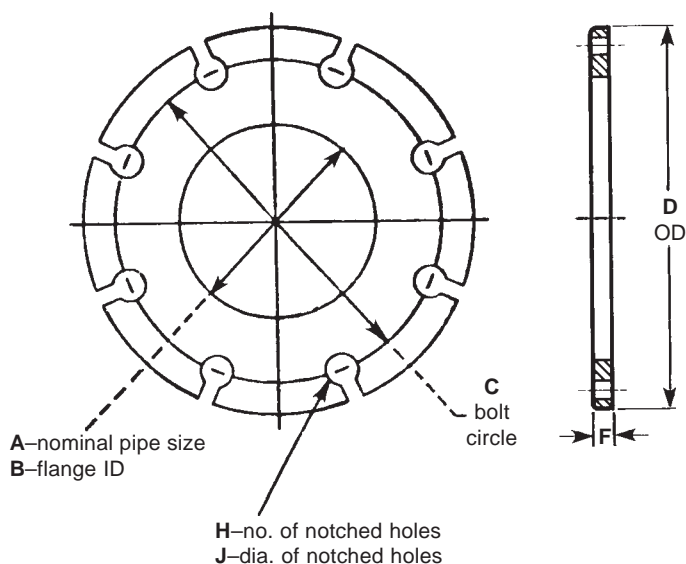

Flange designation	dimensions in inches						
	A	B	C	D	F	H	J
8767E-5	2 <sup>1</sup> / <sub>2</sub>	2 <sup>15</sup> / <sub>16</sub>	5 <sup>1</sup> / <sub>2</sub>	7	<sup>3</sup> / <sub>8</sub>	4	<sup>3</sup> / <sub>4</sub>
8767E-6	3	3 <sup>9</sup> / <sub>16</sub>	6	7 <sup>1</sup> / <sub>2</sub>	<sup>3</sup> / <sub>8</sub>	4	<sup>3</sup> / <sub>4</sub>
8767E-7	4	4 <sup>9</sup> / <sub>16</sub>	7 <sup>1</sup> / <sub>2</sub>	9	<sup>3</sup> / <sub>8</sub>	8	<sup>3</sup> / <sub>4</sub>
8767E-8	6	6 <sup>11</sup> / <sub>16</sub>	9 <sup>1</sup> / <sub>2</sub>	11	<sup>1</sup> / <sub>2</sub>	8	<sup>7</sup> / <sub>8</sub>
8767E-9	8	8 <sup>11</sup> / <sub>16</sub>	11 <sup>3</sup> / <sub>4</sub>	13 <sup>1</sup> / <sub>2</sub>	<sup>1</sup> / <sub>2</sub>	8	<sup>7</sup> / <sub>8</sub>
8767E-10	10	10 <sup>7</sup> / <sub>8</sub>	14 <sup>1</sup> / <sub>4</sub>	16	<sup>1</sup> / <sub>2</sub>	12	1
8767E-12	12	12 <sup>7</sup> / <sub>8</sub>	17	19	<sup>1</sup> / <sub>2</sub>	12	1
8767E-14	14	14 <sup>3</sup> / <sub>16</sub>	18 <sup>3</sup> / <sub>4</sub>	21	<sup>5</sup> / <sub>8</sub>	12	1 <sup>1</sup> / <sub>8</sub>
8767E-16	16	16 <sup>3</sup> / <sub>16</sub>	21 <sup>1</sup> / <sub>4</sub>	23 <sup>1</sup> / <sub>2</sub>	<sup>5</sup> / <sub>8</sub>	16	1 <sup>1</sup> / <sub>8</sub>
8767E-18	18	18 <sup>3</sup> / <sub>16</sub>	22 <sup>3</sup> / <sub>4</sub>	25	<sup>5</sup> / <sub>8</sub>	16	1 <sup>1</sup> / <sub>4</sub>
8767E-20	20	20 <sup>3</sup> / <sub>16</sub>	25	27 <sup>1</sup> / <sub>2</sub>	<sup>5</sup> / <sub>8</sub>	20	1 <sup>1</sup> / <sub>4</sub>
8767E-22	22		Unavailable--see 8767D Flange data				
8767E-24	24	24 <sup>1</sup> / <sub>4</sub>	29 <sup>1</sup> / <sub>2</sub>	32	<sup>3</sup> / <sub>4</sub>	20	1 <sup>3</sup> / <sub>8</sub>
8767E-26	26		Unavailable--see 8767D Flange data				
8767E-28	28		Unavailable--see 8767D Flange data				
8767E-30	30	30 <sup>1</sup> / <sub>4</sub>	36	38 <sup>3</sup> / <sub>4</sub>	<sup>3</sup> / <sub>4</sub>	28	1 <sup>3</sup> / <sub>8</sub>

\*Non-ANSI rated for low pressure combustion air only.

DIMENSIONS SHOWN ARE SUBJECT TO CHANGE. PLEASE OBTAIN CERTIFIED PRINTS FROM NORTH AMERICAN MFG. CO. IF SPACE LIMITATIONS OR OTHER CONSIDERATIONS MAKE EXACT DIMENSION(S) CRITICAL.

**WARNING:** Situations dangerous to personnel and property can develop from incorrect operation of combustion equipment. North American urges compliance with National Safety Standards and Insurance Underwriters recommendations, and care in operation.

North American Manufacturing Company, 4455 East 71st Street, Cleveland, OH 44105-5600 USA,  
Tel +1.216.271.6000 • Fax +1.216.641.7852 email: sales@namfg.com • www.namfg.com